

**GARD-DECK TRAFFIC COATING SYSTEM (Unreinforced)**

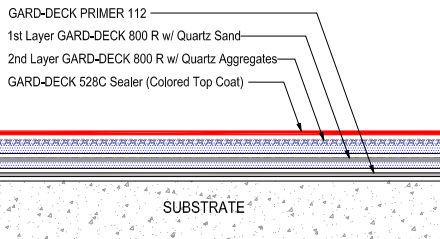

**GARD-DECK TRAFFIC COATING SYSTEM (Reinforced)**

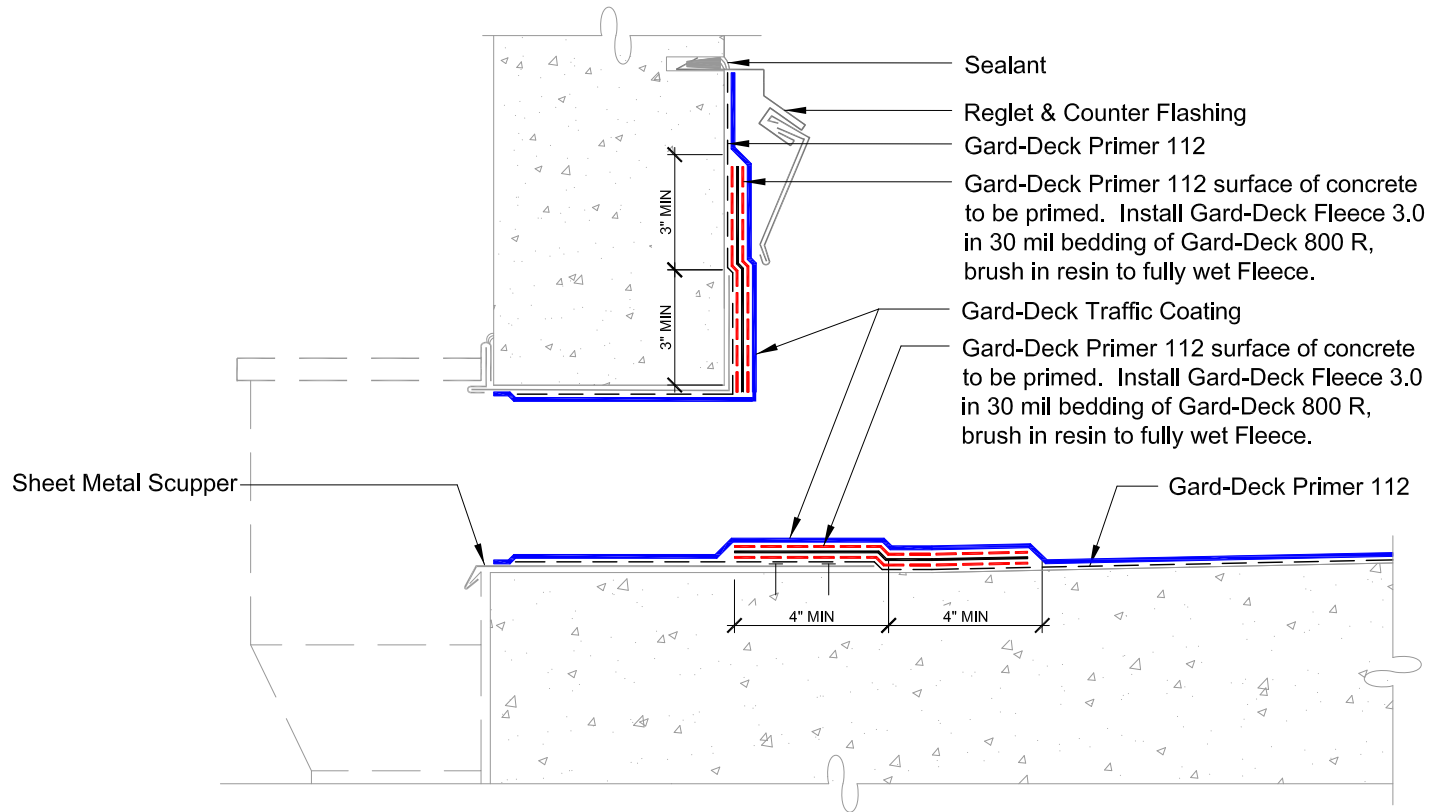
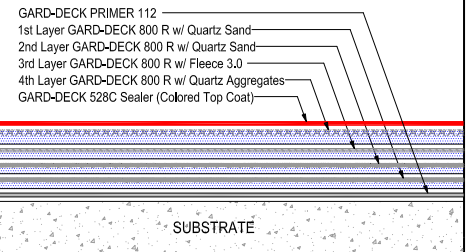

Sealant

Reglet & Counter Flashing

Gard-Deck Primer 112

Gard-Deck Primer 112 surface of concrete to be primed. Install Gard-Deck Fleece 3.0 in 30 mil bedding of Gard-Deck 800 R, brush in resin to fully wet Fleece.

Gard-Deck Traffic Coating

Gard-Deck Primer 112 surface of concrete to be primed. Install Gard-Deck Fleece 3.0 in 30 mil bedding of Gard-Deck 800 R, brush in resin to fully wet Fleece.



DETAIL NAME:

**SCUPPER**

JOB NAME:

Scale:

NTS

Date:

04-17-17

Drawing #:

GD-013.1